

*American Standard*

**Exposed Wall Mount  
Sink Faucet  
Llave de Lavabo Expuesta  
de Montaje en Pared  
Robinet d'évier à fixation  
murale exposée**

MODEL NUMBER  
NÚMERO DE MODELO  
NUMÉRO DU MODÈLE

**7295.152  
7295.252  
7295.252F15**



**012263-0020A**  
SOAP DISH  
JABONERA  
PORTE-SAVONNETTE



**012264-0070A**  
POST & RETAINER  
POSTE Y RETEN  
TIGE ET RETENUE



**012258-0020A**  
CONNECTING POST  
POSTE CONECTOR  
TIGE DE CONNEXION

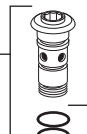

**012256-0070A**  
SPOUT SEAL AND BEARING  
SELLO DE LA BOQUILLA Y RODAMIENTO  
JOINTS ET PALIER DU BEC

**012255-0020A**  
5-5/8" SPOUT  
BOQUILLA DE 5-5/8"  
BEC 14 cm (5-5/8 po)

**M923825-YYYOA (2.2 GPM)**  
AERATOR  
OXIGENADOR  
AÉRATEUR

**M922881-0020A (1.5 GPM)**  
AERATOR  
OXIGENADOR  
AÉRATEUR

**012245-YYYOA**  
HANDLE  
MANIJA  
MANETTE

**012254-YYYOA**  
HANDLE SCREW  
TORNILLO DEL ASA  
VIS DE MANETTE

**A994053-0070A**  
CARTRIDGE  
CARTUCHO  
CARTOUCHE

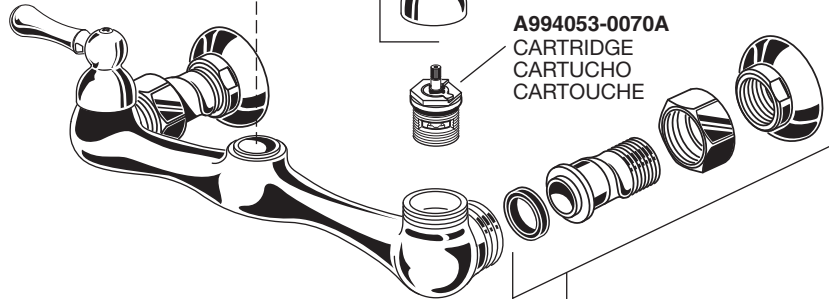

**(OLD NUMBER) 014319-YYYOA**  
**(AFTER MAY, 1 2010) M962962-YYYOA**  
FEMALE ECCENTRIC SHANK KIT  
KIT DE ESPIGA HEMBRA  
EXCENTRICA  
KIT DE QUEUE EXCENTRIQUE  
FEMELLE

Appropriate finish code  
Acabado correspondiente  
Code de fini approprié

**CHROME, CROMO, CHROME 002**

**HOTLINE FOR HELP    NUMERO DE EMERGENCIA    ASSISTANCE TÉLÉPHONIQUE**



For toll-free information and answers to your questions, call:  
Para información y respuestas a sus preguntas, llame sin costo al:  
Pour information et réponses à vos questions, composer sans frais:

1 800 442-1902  
Weekdays    Días laborales de las    Sur semaine:  
8:00 a.m. to 8:00 p.m. EST  
CANADA 1-800-387-0369 (TORONTO 1-905-306-1093)  
Weekdays    Días laborales de las    Sur semaine:  
8:00 to 7:00 p.m. EST

IN MEXICO 01-800-839-1200

Product names listed herein are trademarks of American Standard Inc.  
© AS America, Inc. 2010

**PART OF LIXIL**

M968129 REV.1.3 (8/16)